

Tools Required
Strumenti Richiesti
Benötigtes Werkzeug

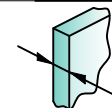

8 ÷ 13.52

GLASS
VETRO
GLAS

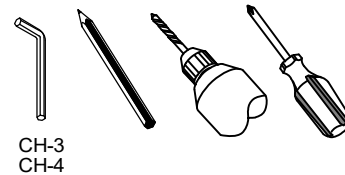
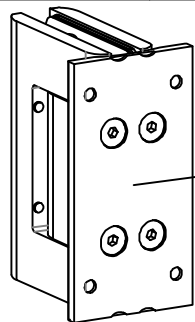

Queste viti sono serrate a 10Nm dalla fabbrica,
e' vietato svitarle o allentarle



These screws are tightened at 10 Nm from the factory,
it is forbidden to unscrew or loosen them

Diese Schrauben werden ab Werk mit 10 Nm angezogen,
Es ist verboten, sie abzuschrauben oder zu l'sen

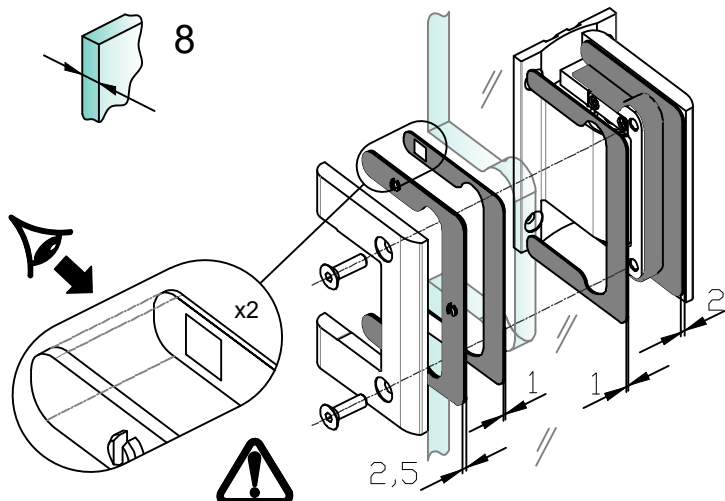

- Check the alignment of the gaskets and then bond them together using the adhesive pads that have already been applied.
- Verificare l'allineamento delle guarnizioni e successivamente incollarle tra loro mediante gli adesivi già applicati.
- Ausrichtung der Dichtungen überprüfen und anschließend mittels bereits aufgebrachtener Klebepads miteinander verkleben.

Gasket
Guarnizioni
Zwischenlagen

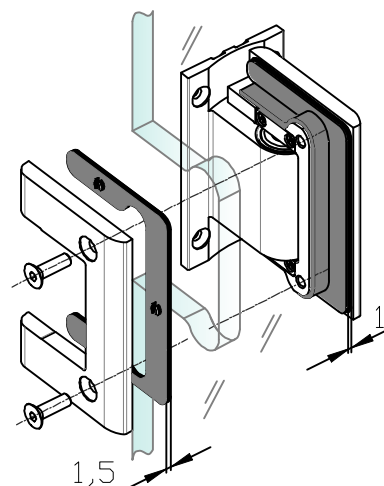
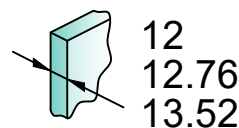
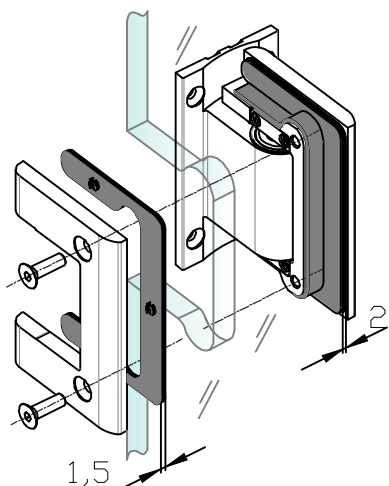
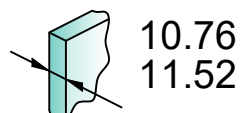
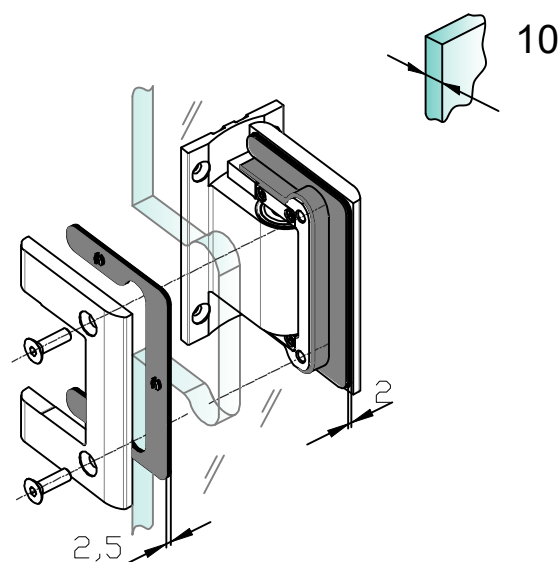



CH - 4 mm
10 Nm
7.4 lbs - ft

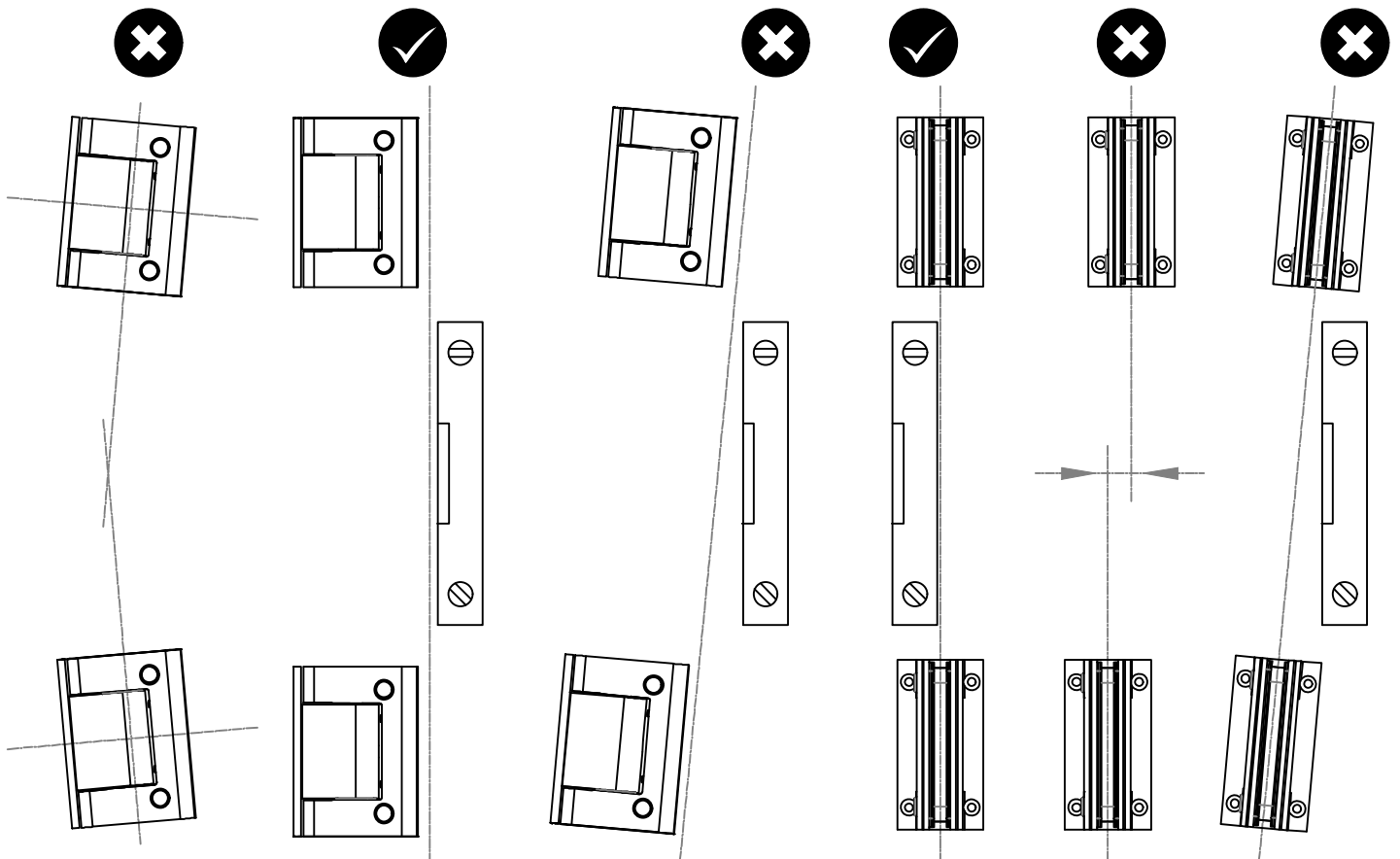
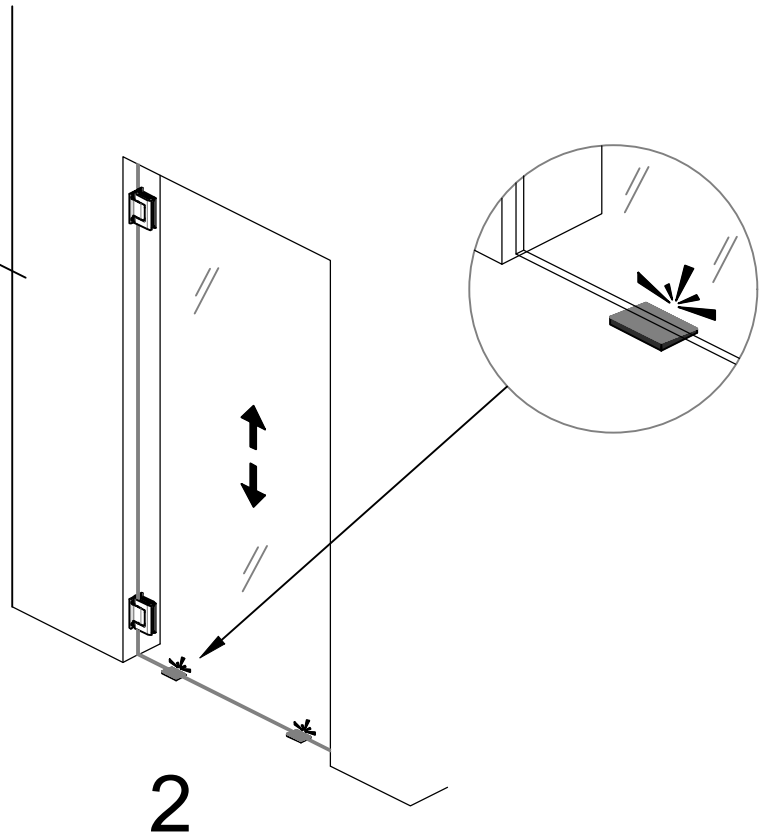
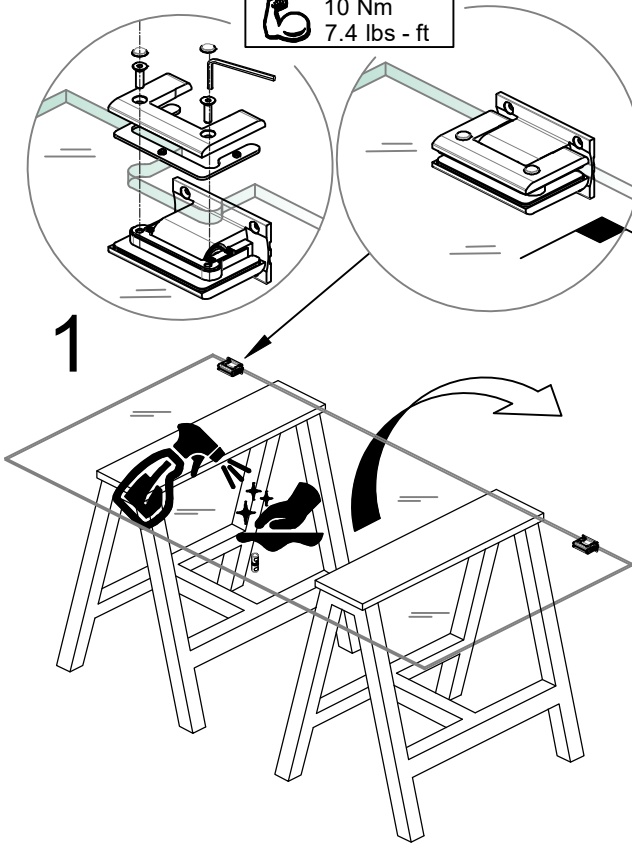

BILOBA

8010 - 8010SOL

More info
Ulteriori informazioni
Mehr Info



3

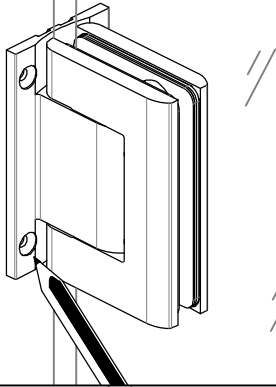

4

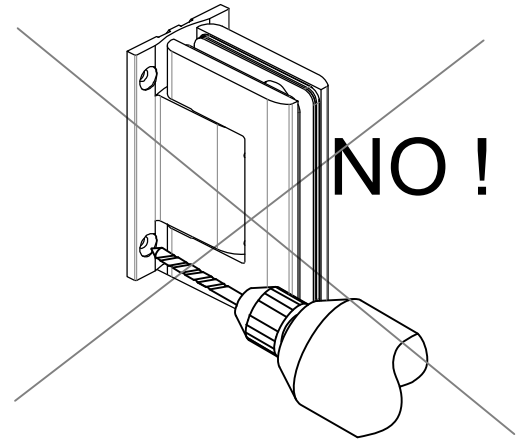
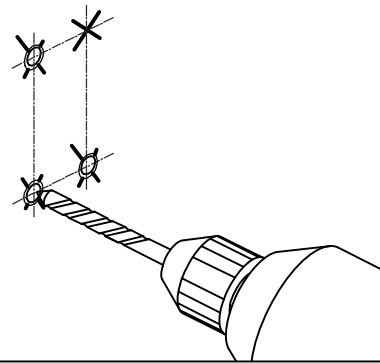

5

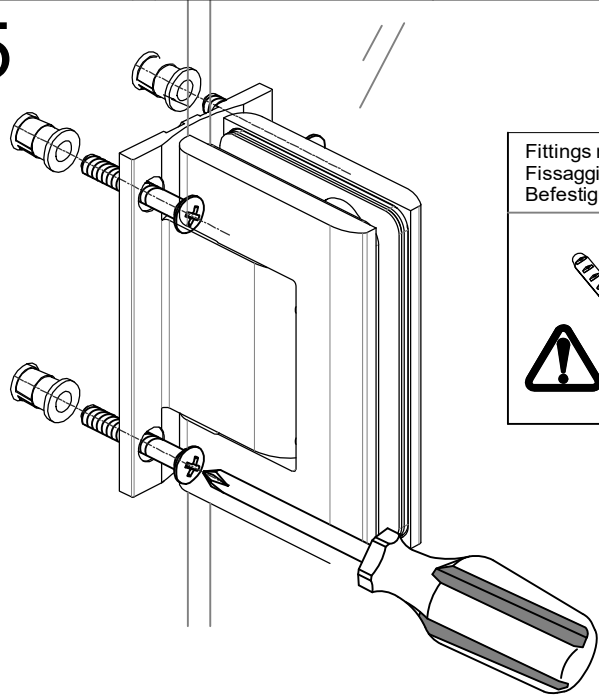

Fittings not included
Fissaggi non inclusi
Befestigungsschrauben

4 x

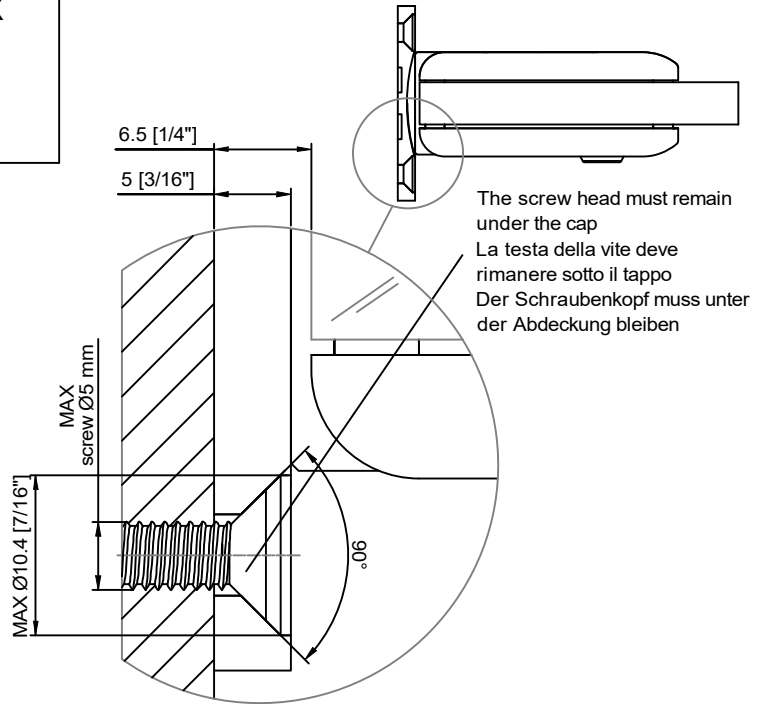

The screw head must remain under the cap
La testa della vite deve rimanere sotto il tappo
Der Schraubenkopf muss unter der Abdeckung bleiben

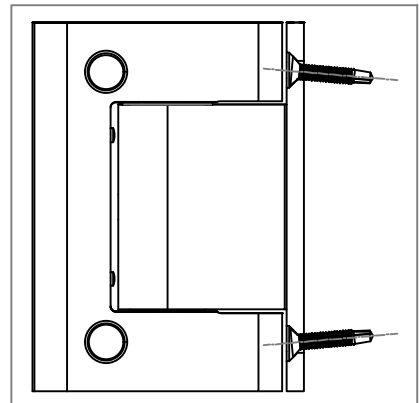
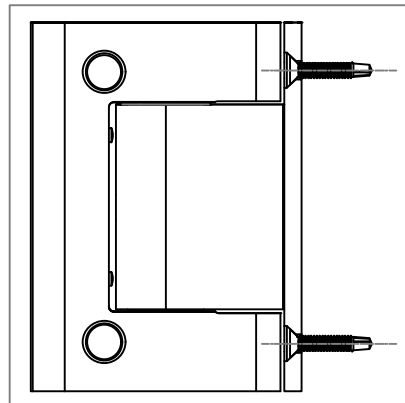
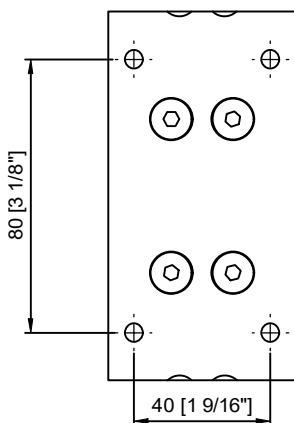
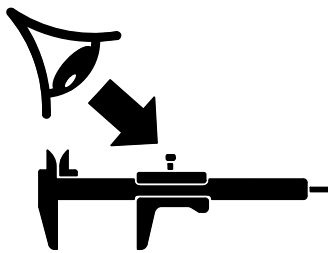



6



ONLY FOR 8010
SOLO PER 8010
NUR FÜR 8010

Closing speed adjustment

Factory settings: average pre-set

Regolazione della velocità di chiusura

Impostazioni di fabbrica: media
preimpostata

Einstellung Schließgeschwindigkeit

Werkseitige Konfiguration:
mittlere Geschwindigkeit

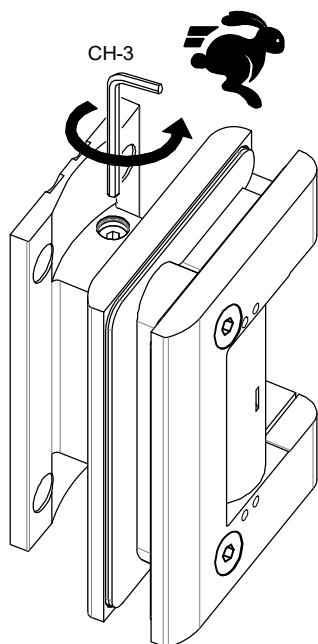

FAST - VELOCE - SCHNELL

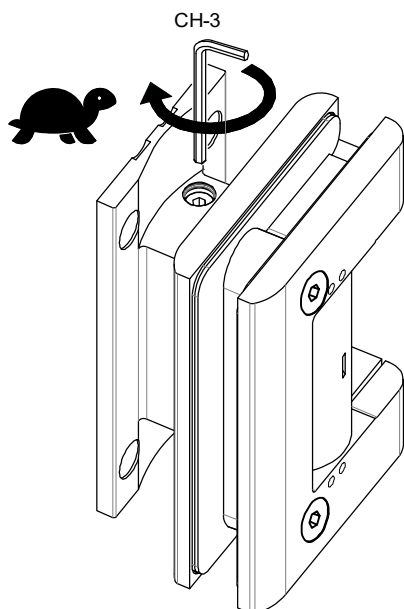
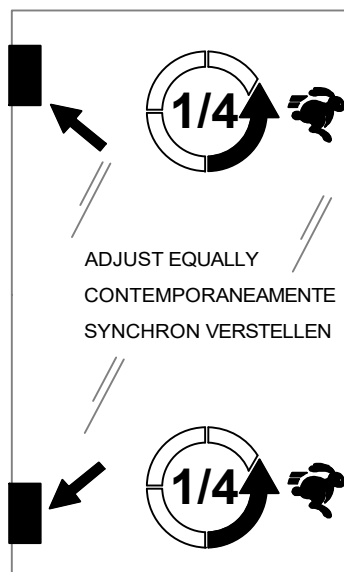

SLOW - LENTO - LANGSAM

