

# VERTO

# 150E00



TOP - SUPERIORE - OBEN

Suggested  
Sugerito  
Empfohlen

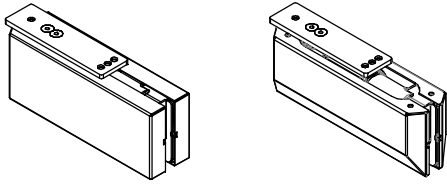

BOTTOM - INFERIORE - UNTEN

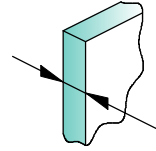
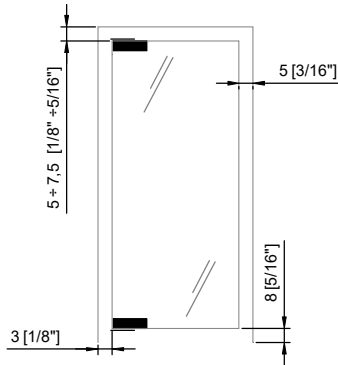
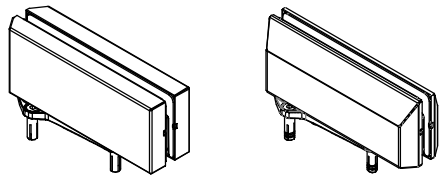

GLASS  
VETRO  
GLAS

8 ÷ 19.5  
5/16" ÷ 3/4"

Tools Required  
Strumenti Richiesti  
Benötigtes Werkzeug

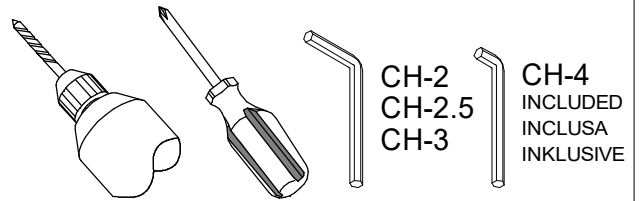

FLOOR BASE PLATE  
PIASTRA BASE A PAVIMENTO  
BODENLAGER

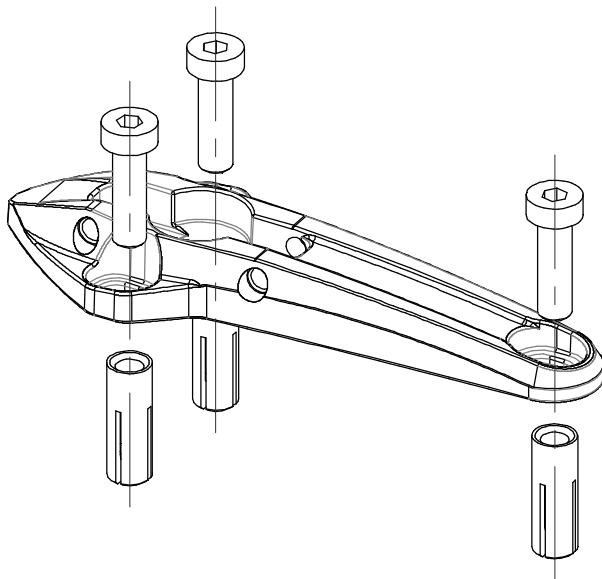

FLOOR BASE PLATE FIXING  
FISSAGGIO PIASTRA BASE A PAVIMENTO  
BEFESTIGUNG BODENLAGER

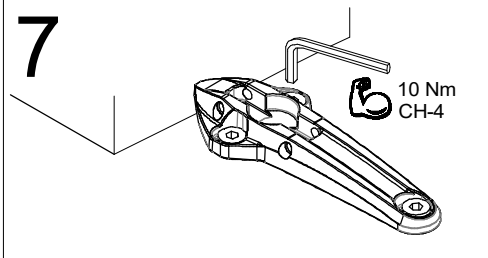
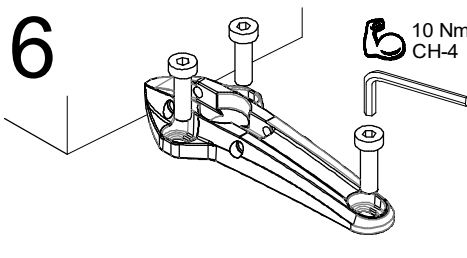
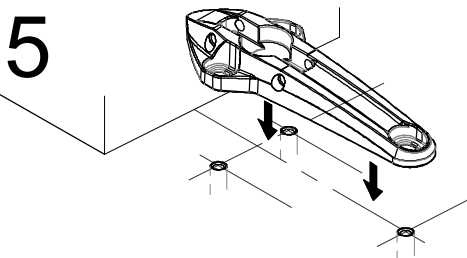
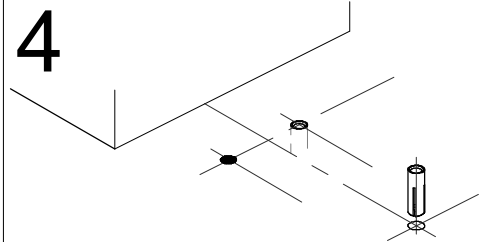
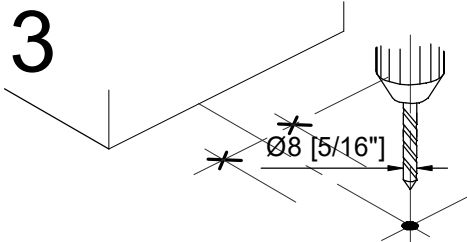
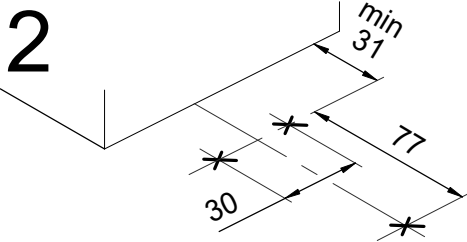
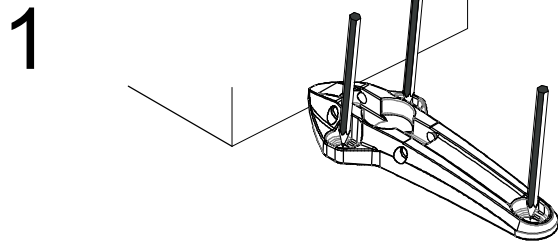
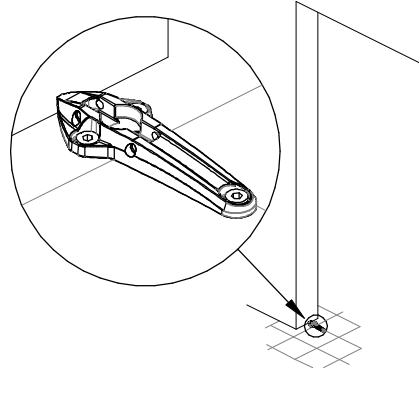



## 8

EXAMPLE: 12mm thick glass  
 ESEMPIO: vetro spessore 12 mm  
 BEISPIEL: 12 mm dickes Glas

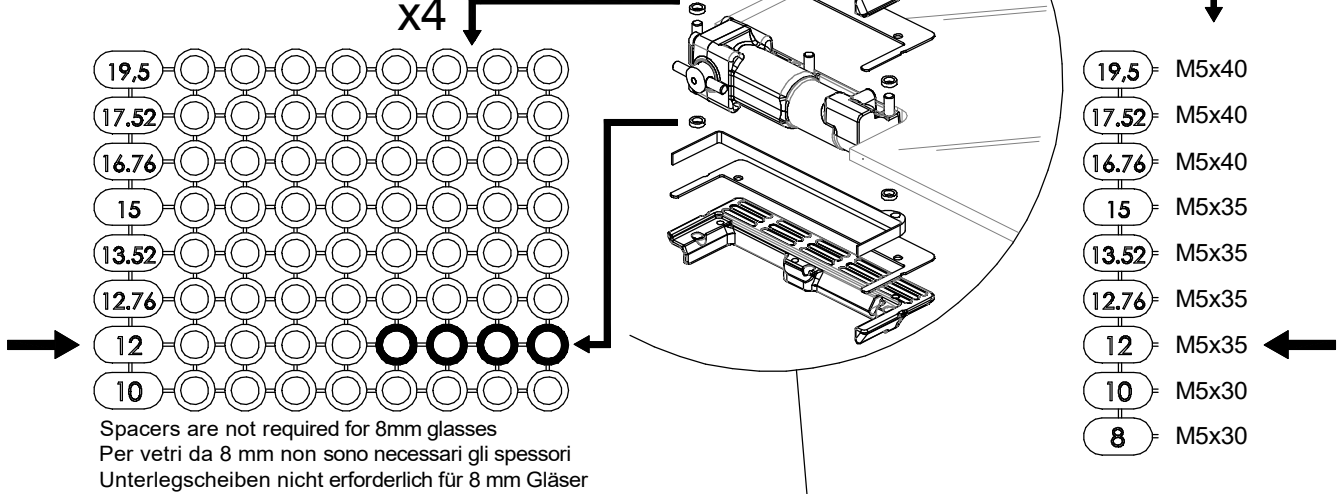

## 9

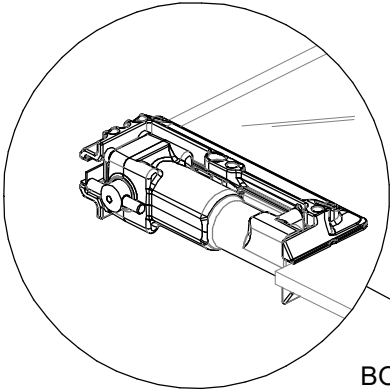
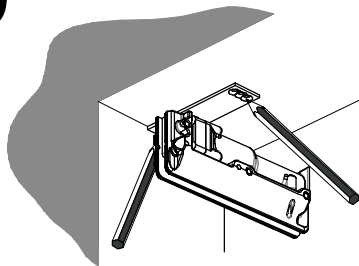

BOTTOM  
 INFERIORE  
 UNTEN

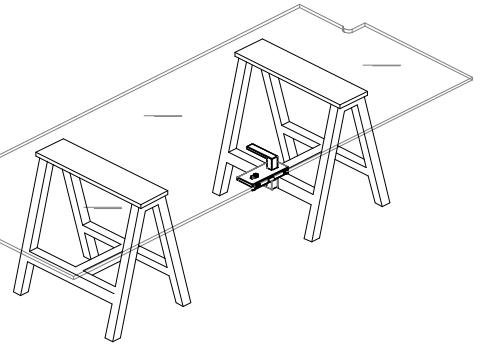

## 10

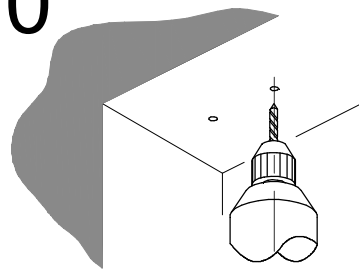

TOP HINGE FIXING  
 FISSAGGIO CERNIERA SUPERIORE  
 BEFESTIGUNG OBERES BAND

DOUBLE WAY  
 DOPPIO SENSO  
 PENDELTÜR

DIN LEFT

LEFT END ONE WAY  
 PORTA BATTENTE A SINISTRA  
 ANSCHLAGTÜR DIN LINKS

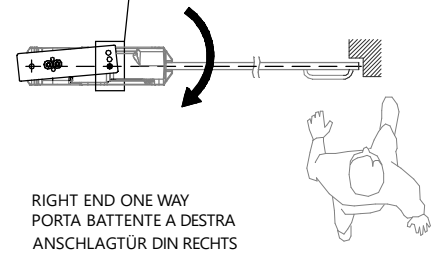
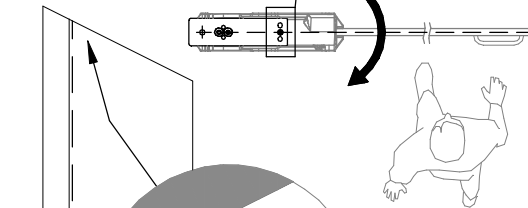

RIGHT END ONE WAY  
 PORTA BATTENTE A DESTRA  
 ANSCHLAGTÜR DIN RECHTS

## 11

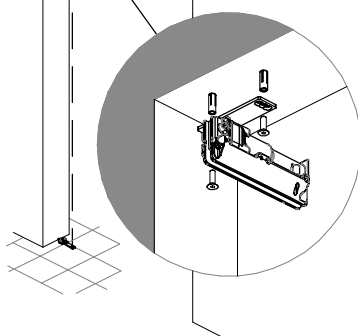
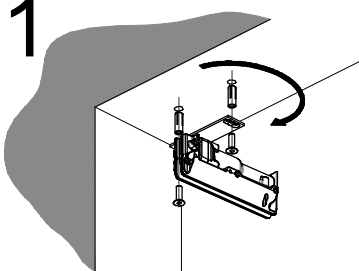

DIN RIGHT





## 17 ADJUSTMENTS REGOLAZIONI EINSTELLUNGEN

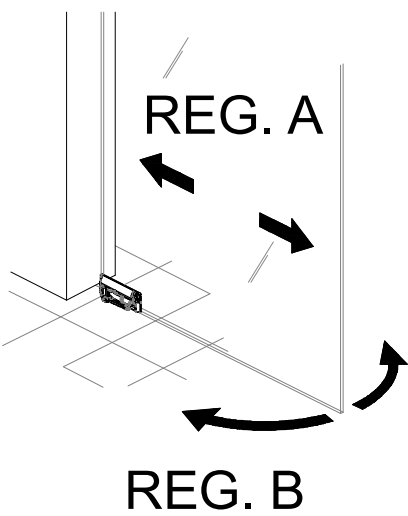

**REG. A**

first adjustment ...  
prima regolazione ...  
erst einstellen...

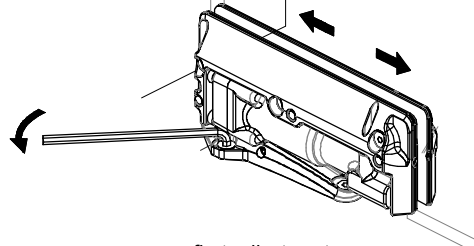

... then LOCK  
... quindi BLOCCARE  
... dann FESTZIEHEN

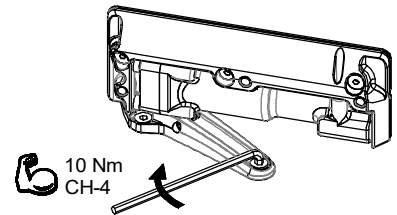

first adjustment ...  
prima regolazione ...  
erst einstellen...

**REG. B**

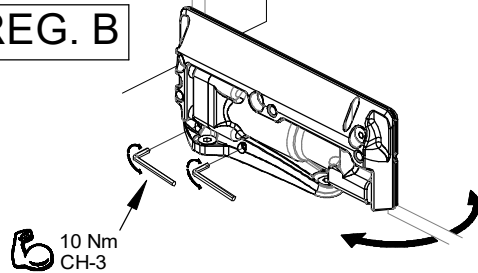

... then LOCK  
... quindi BLOCCARE  
... dann FESTZIEHEN

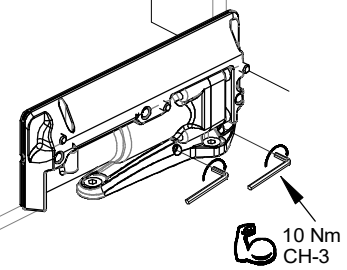

## 18 ADJUSTMENTS REGOLAZIONI EINSTELLUNGEN

Tighten clockwise to slow down the closing speed and untighten to increase the speed.

Avvitare in senso orario per rallentare la velocità di chiusura e svitare per accelerare.

Gegen den Uhrzeigersinn drehen und im Uhrzeigersinn festziehen, um die Schließgeschwindigkeit zu verringern.

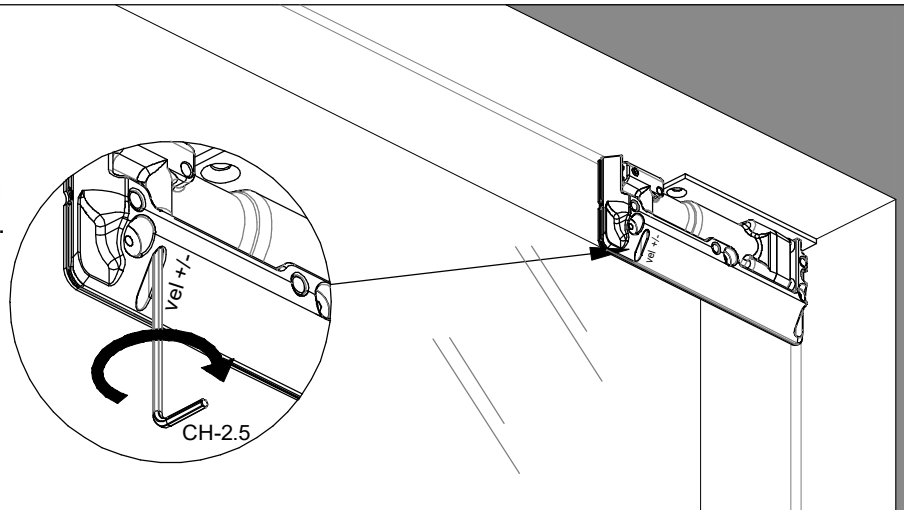
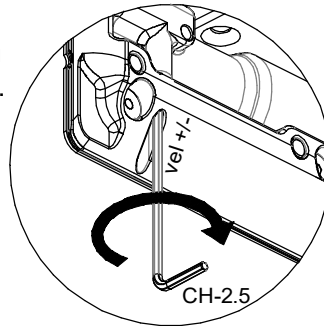

## 19 COVERS

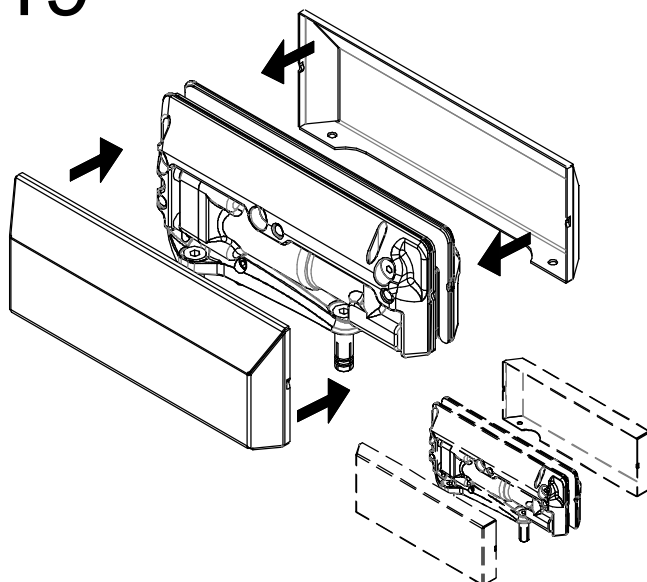

↑ TOP - SUPERIORE - OBEN

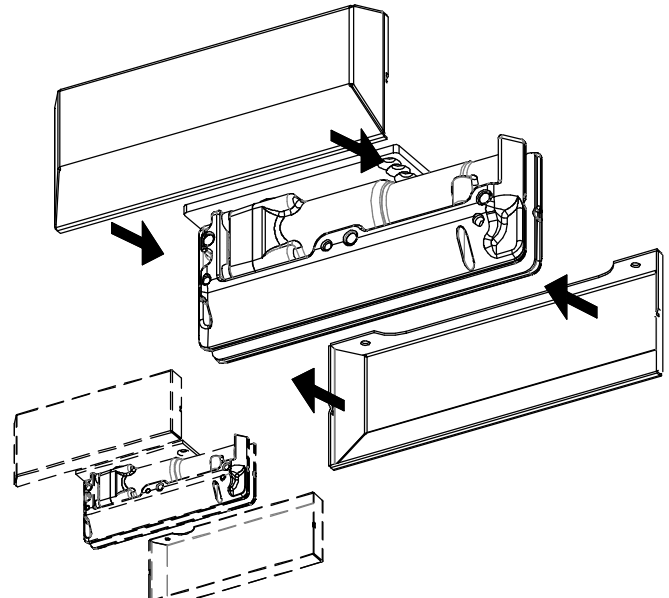

↓ BOTTOM - INFERIORE - UNTEN